



Programmable Controller
MELSEC iQ-F

Side A JAPANESE
Side B ENGLISH
Side C CHINESE

MELSEC iQ-F FX5-485-BD

Hardware Manual



Manual Number	JY997D54001
Revision	K
Date	July 2023

This manual describes the part names, dimensions, installation, and specifications of the product. Before use, read this manual and manuals of relevant products fully to acquire proficiency in handling and operating the product. Make sure to learn all the product information, safety information, and precautions.

And, store this manual in a safe place so that you can take it out and read it whenever necessary. Always forward it to the end user.

Registration:

The company names, system names and product names mentioned in this manual are either registered trademarks or trademarks of their respective companies. In some cases, trademark symbols such as "™" or "®" are not specified in this manual.

Effective July 2023
Specifications are subject to change without notice.

Safety Precautions (Read these precautions before use.)

This manual classifies the safety precautions into two categories:

WARNING and **CAUTION**

WARNING	Indicates that incorrect handling may cause hazardous conditions, resulting in death or severe injury.
CAUTION	Indicates that incorrect handling may cause hazardous conditions, resulting in minor or moderate injury or property damage.

Depending on the circumstances, procedures indicated by **CAUTION** may also cause severe injury.

It is important to follow all precautions for personal safety.

Associated Manuals

Manual name	Manual No.	Description
MELSEC iQ-F FX5S/FX5UJ/FX5U/FX5UC User's Manual (Hardware)	SH-082452ENG	Describes the details of hardware of the CPU module, including performance specifications, wiring, installation, and maintenance.
MELSEC iQ-F FX5 User's Manual (Communication)	SH-082625ENG	Describes the communication function of the built-in CPU module and the Ethernet module.

For wiring with communication equipment, system configuration, communication settings, and program examples, refer to the following manual.

→ MELSEC iQ-F FX5 User's Manual (Communication)

How to obtain manuals

For the necessary product manuals or documents, consult with your local Mitsubishi Electric representative.

Applicable standards

FX5-485-BD complies with the EU Directive (EMC Directive) and UKCA marking. Further information can be found in the following manual.

→ MELSEC iQ-F FX5S/FX5UJ/FX5U/FX5UC User's Manual (Hardware)

Regarding the standards that relate to the CPU module, please refer to either the product catalog or consult with your nearest Mitsubishi product provider.

Attention

This product is designed for use in industrial applications.

1. Outline

FX5-485-BD is an expansion board equipped with an European terminal block for RS-485 communication. The FX5-485-BD exchanges data with RS-485 devices.

1.1 Incorporated Items

Check that the following product and items are included in the package:

Product	FX5-485-BD communication board
Included items	M3×8 tapping screws for installation: 2 pcs. Hardware Manual (This manual)

1.2 Communication Function

MELSOFT connection, MELSEC Communication protocol (1C/3C/4C frames), Non-protocol communication, MODBUS RTU, Inverter communication, N:N network, Parallel link, Predefined protocol support

1.3 External Dimensions and Part Names

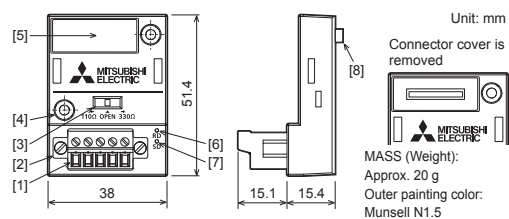

- [1] RS-485 communication terminal block (European terminal block)
- [2] Terminal block mounting screws
- [3] Terminal resistor selector switch (110 Ω/OPEN/330 Ω)
- [4] Mounting holes (2-φ3.2)
- [5] Connector cover
- [6] RD LED (green): Lighting while receiving data
- [7] SD LED (green): Lighting while sending data
- [8] CPU module connector

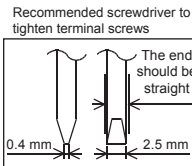

Use a tool such as a screwdriver to operate the terminal resistor selector switch. Make sure that the edge of the tool does not damage the switch or the case.

1.4 Terminal Configuration

SG SDB SDAR DBR DA	Signal name	Function
○	RDA (RXD+)	Receive data
○	RDB (RXD-)	
○	SDA (TXD+)	Send data
○	SDB (TXD-)	
○	SG (GND)	Signal ground

2. Installation

INSTALLATION PRECAUTIONS **WARNING**

- Make sure to cut off all phases of the power supply externally before attempting installation or wiring work. Failure to do so may cause electric shock or damage to the product.
- Use the product within the generic environment specifications described in the User's Manual (Hardware) of the CPU module used. Never use the product in areas with excessive dust, oily smoke, conductive dusts, corrosive gas (salt air, Cl₂, H₂S, SO₂ or NO₂), flammable gas, vibration or impacts, or expose it to high temperature, condensation, or rain and wind. If the product is used in such conditions, electric shock, fire, malfunctions, deterioration or damage may occur.

INSTALLATION PRECAUTIONS **CAUTION**

- Do not touch the conductive parts of the product directly. Doing so may cause device failures or malfunctions.
- When drilling screw holes or wiring, make sure that cutting and wiring debris do not enter the ventilation slits of the PLC. Failure to do so may cause fire, equipment failures or malfunctions.
- Connect the expansion board and expansion adapter securely to their designated connectors. Loose connections may cause malfunctions.
- Make sure to affix the expansion board with tapping screws. Tightening torque should follow the specifications in the manual. If the screws are tightened outside of the specified torque range, poor connections may cause malfunctions.
- Work carefully when using a screwdriver such as installation of the product. Failure to do so may cause damage to the product or accidents.

For the installation, refer to the following manual.

→ MELSEC iQ-F FX5S/FX5UJ/FX5U/FX5UC User's Manual (Hardware)

3. Specifications

STARTUP AND MAINTENANCE PRECAUTIONS **CAUTION**

- Do not disassemble or modify the PLC. Doing so may cause fire, equipment failures, or malfunctions. For repair, contact your local Mitsubishi Electric representative.
- Do not drop the product or exert strong impact to it. Doing so may cause damage.

DISPOSAL PRECAUTIONS **CAUTION**

- Please contact a certified electronic waste disposal company for the environmentally safe recycling and disposal of your device.

TRANSPORTATION PRECAUTIONS **CAUTION**

- The product is a precision instrument. During transportation, avoid impacts larger than those specified in the general specifications by using dedicated packaging boxes and shock-absorbing pallets. Failure to do so may cause failures in the product. After transportation, verify operation of the product and check for damage of the mounting part, etc.

3.1 Applicable CPU module

Model name	Applicability
FX5S CPU module	From first production
FX5UJ CPU module	From first production
FX5U CPU module	From first production

For details on the system configuration, refer to the following manual.

→ MELSEC iQ-F FX5 User's Manual (Communication)

3.2 General Specifications

The general specifications are equivalent to the CPU module. For general specifications, refer to the following manual. However, since the product is not isolated between communication lines and the CPU module, please do not perform any dielectric withstand voltage tests or insulation resistance tests to this product.

→ MELSEC iQ-F FX5S/FX5UJ/FX5U/FX5UC User's Manual (Hardware)

3.3 Power Supply Specification

Item	Specification
Rated voltage ^{*1}	5 V DC
Current consumption ^{*1}	20 mA

*1 Power is supplied internally from the CPU module.

3.4 Performance specifications

Item	Specification
Transmission standard	Conforming to RS-485/RS-422
Maximum transmission distance	50 m
Connection method	European terminal block
Terminal resistor	Built-in (OPEN/110 Ω/330 Ω)
Insulation	Not insulated (Between communication line and CPU module)
Communication method ^{*1}	Half-duplex/Full-duplex
Baud rate ^{*1}	300/600/1200/2400/4800/9600/19200/38400/57600/115200 (bps)

*1 The communication method and baud rate vary depending on the types of the communication.

This manual confers no industrial property rights or any rights of any other kind, nor does it confer any patent licenses. Mitsubishi Electric Corporation cannot be held responsible for any problems involving industrial property rights which may occur as a result of using the contents noted in this manual.

Warranty

Exclusion of loss in opportunity and secondary loss from warranty liability
Regardless of the gratis warranty term, Mitsubishi shall not be liable for compensation to:
(1) Damages caused by any cause found not to be the responsibility of Mitsubishi.
(2) Loss in opportunity, lost profits incurred to the user by Failures of Mitsubishi products.
(3) Special damages and secondary damages whether foreseeable or not, compensation for accidents, and compensation for damages to products other than Mitsubishi products.
(4) Replacement by the user, maintenance of on-site equipment, start-up test run and other tasks.

For safe use

- This product has been manufactured as a general-purpose part for general industries, and has not been designed or manufactured to be incorporated in a device or system used in purposes related to human life.
- Before using the product for special purposes such as nuclear power, electric power, aerospace, medicine or passenger movement vehicles, consult with Mitsubishi Electric.
- This product has been manufactured under strict quality control. However when installing the product where major accidents or losses could occur if the product fails, install appropriate backup or failsafe functions in the system.